



## Redwing Close, Oakham

This modern three-bedroom semi-detached family home is ideally situated in a quiet cul-de-sac, just a short walk from the heart of Oakham.



### FEATURES

- Semi Detached Family Home
- NO ONWARD CHAIN
- Kitchen Diner
- Three Bedrooms
- Enclosed Rear Garden
- Off Road Parking
- Walking Distance To Amenities





Accommodation comprises; Entrance hall, spacious sitting room featuring a gas fire. Kitchen diner equipped with a range of base units, worktop space, and a stainless steel sink and drainer. Includes plumbing for appliances, a radiator, a pantry, and a door leading to the rear garden. To the first floor are two double bedrooms, single bedroom and a family bathroom featuring a three-piece suite.



To book a viewing call our area experts

[www.mooresestateagents.com](http://www.mooresestateagents.com)

Moore's Property Hub 01572 757979 | Moore's Move to the Country 020 301 11361  
Melton 01664 491610 | Uppingham 01572 821935 | Stamford 01780 484555  
Grantham Meet & Greet 01476 855618 | Peterborough Meet & Greet 01733 788888  
A1 Meet & Greet Stoke Rochford | [office@mooresestateagents.com](mailto:office@mooresestateagents.com)



The property is accessed via a tarmac driveway providing parking for two or more vehicles and side access to the rear garden which is mainly laid to lawn with patio area, fully enclosed and private.

Oakham is a popular market town in the small county of Rutland. The town is home to multiple schools catering for all ages as well as services such as a library, doctors surgery and numerous restaurants, coffee shops, super markets and boutique shops.





## Ground Floor

Approx. 32.7 sq. metres (351.7 sq. feet)

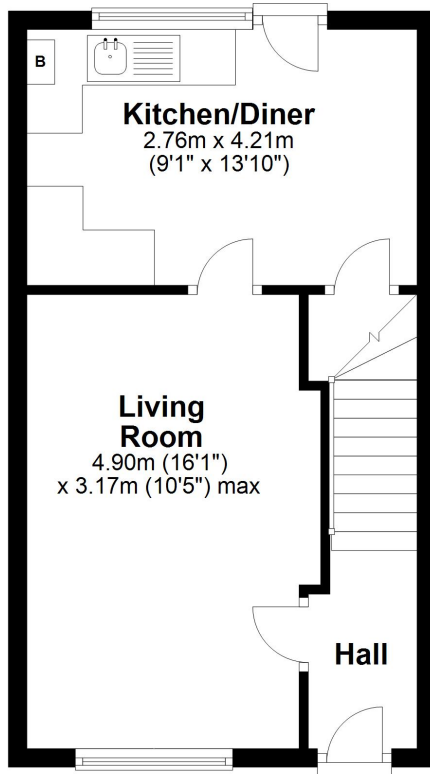

## First Floor

Approx. 32.8 sq. metres (353.3 sq. feet)

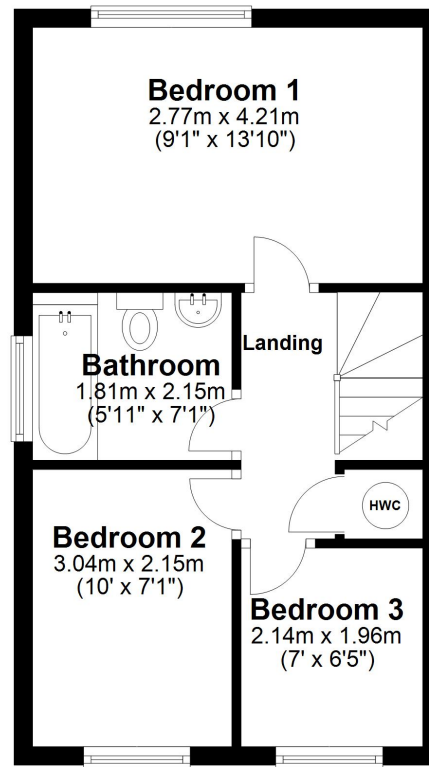

Total area: approx. 65.5 sq. metres (704.9 sq. feet)

This floor plan is not to scale. They are for guidance only and accuracy is not guaranteed. Plan was produced by ADR Energy Assessors  
Plan produced using PlanUp.

## EPC RATING

Address: 17 Redwing Close, OAKHAM, LE15 6DA  
RRN: 5100-4062-0222-7490-3843

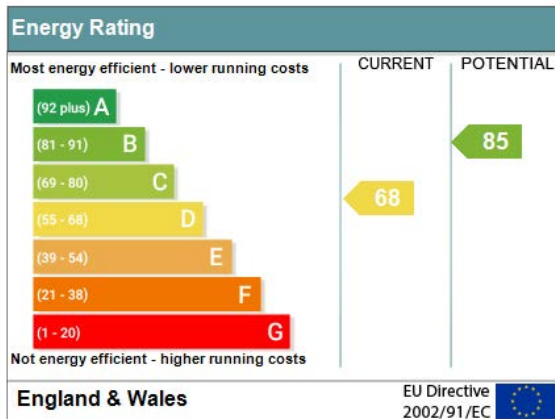

**to book a viewing call our area experts**

Moores Property Hub 01572 757979  
Moores Move to the Country 020 301 11361  
Melton 01664 491610  
Uppingham 01572 821935  
Stamford 01780 484555  
Grantham Meet & Greet 01476 855618  
Peterborough Meet & Greet 01733 788888  
A1 Meet & Greet Stoke Rochford

office@mooresestateagents.com

**Follow us for Property Updates**



@mooresestateagents



@mooresestateagents

[www.mooresestateagents.com](http://www.mooresestateagents.com)

**Click the images below to view our Area Minute Guides**

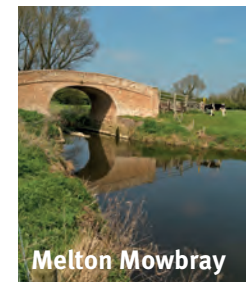
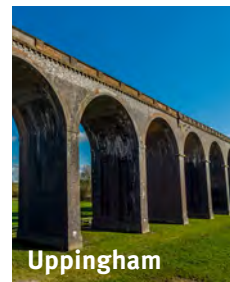
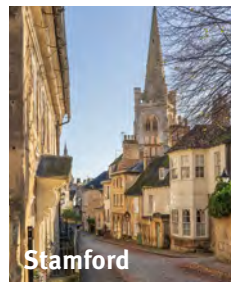

Moore V Ltd trading as Moores Estate Agents gives notice that: 1. These particulars do not constitute an offer or contract or part thereof. 2. All descriptions, photographs and plans are for guidance only and should not be relied upon as statements or representations of fact. All measurements are approximate and not necessarily to scale. Any prospective purchaser must satisfy themselves of the correctness of the information within the particulars by inspection or otherwise. 3. Moore V Ltd trading as Moores Estate Agents does not have any authority to give any representations or warranties whatsoever in relation to this property (including but not limited to planning/building regulations), nor can it enter into any contract on behalf of the Vendor. 4. Moore V Ltd trading as Moores Estate Agents does not accept responsibility for any expenses incurred by prospective purchasers in inspecting properties which have been sold, let or withdrawn. 5. If there is anything of particular importance to you, please contact this office and we will try to have the information checked for you.